

VISITOR GUIDE



UNCOVER THE LIFE BEFORE YOU

A MUSEUM FOR EVERYONE

Get up close to the Northwest's past, present, and future at the Burke. Featuring 12 state-of-the-art visible labs, views into collections storage spaces and an artists' workshop, see the work typically happening behind the scenes of a natural history and culture museum unfold right before your eyes.

At the Burke, you see—and feel—a world alive. Regardless of who you are or where you came from—whether your family just got here or has called this land home for millennia—**this is your museum.**

LAND ACKNOWLEDGEMENT

The Burke Museum stands on the lands of the Coast Salish peoples, whose ancestors resided here since time immemorial. Many Indigenous peoples thrive in this place—alive and strong.

MISSION

The Burke Museum cares for and shares natural and cultural collections so all people can **learn, be inspired, generate knowledge, feel joy, and heal.**

AFFILIATIONS





LOWER FLOOR

Lower Lobby/Grand Atrium

East Classroom

West Classroom

-  Accessible Restrooms + Changing Tables
-  Stroller Parking
-  Elevator

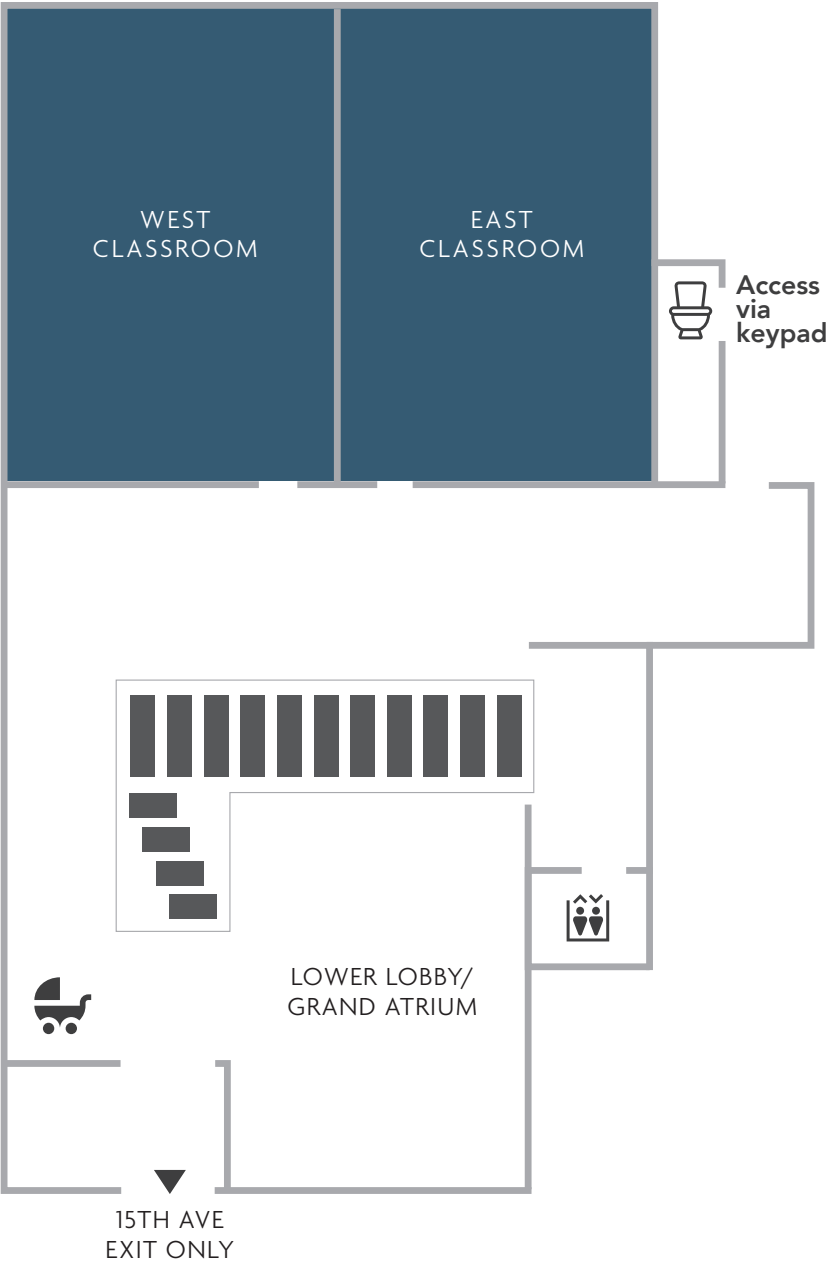

LOWER FLOOR HIGHLIGHTS

Iconic objects of the natural history and cultures of Washington state welcome you to the Burke Museum and University of Washington campus.

MASTODON This 10,000-year-old mastodon helps us understand what life once looked like in the Pacific Northwest

THE WEAVER'S WELCOME This newly-commissioned piece—created by a team of Coast Salish artists—is a glass figure cast from hand-carved wood sculptures

BAIRD'S BEAKED WHALE Is one of 10 Baird's beaked whales in U.S. museum collections and offers incredible insights into a species that is rarely seen or studied



PETRIFIED LOGS These rocks were once trees that grew in eastern Washington 15 million years ago



FIRST FLOOR

Contemporary Culture

Culture is Living Gallery
Northwest Native Art Gallery
Main Lobby

-  Accessible Restrooms + Changing Tables
-  See-Through Locations
-  Elevator

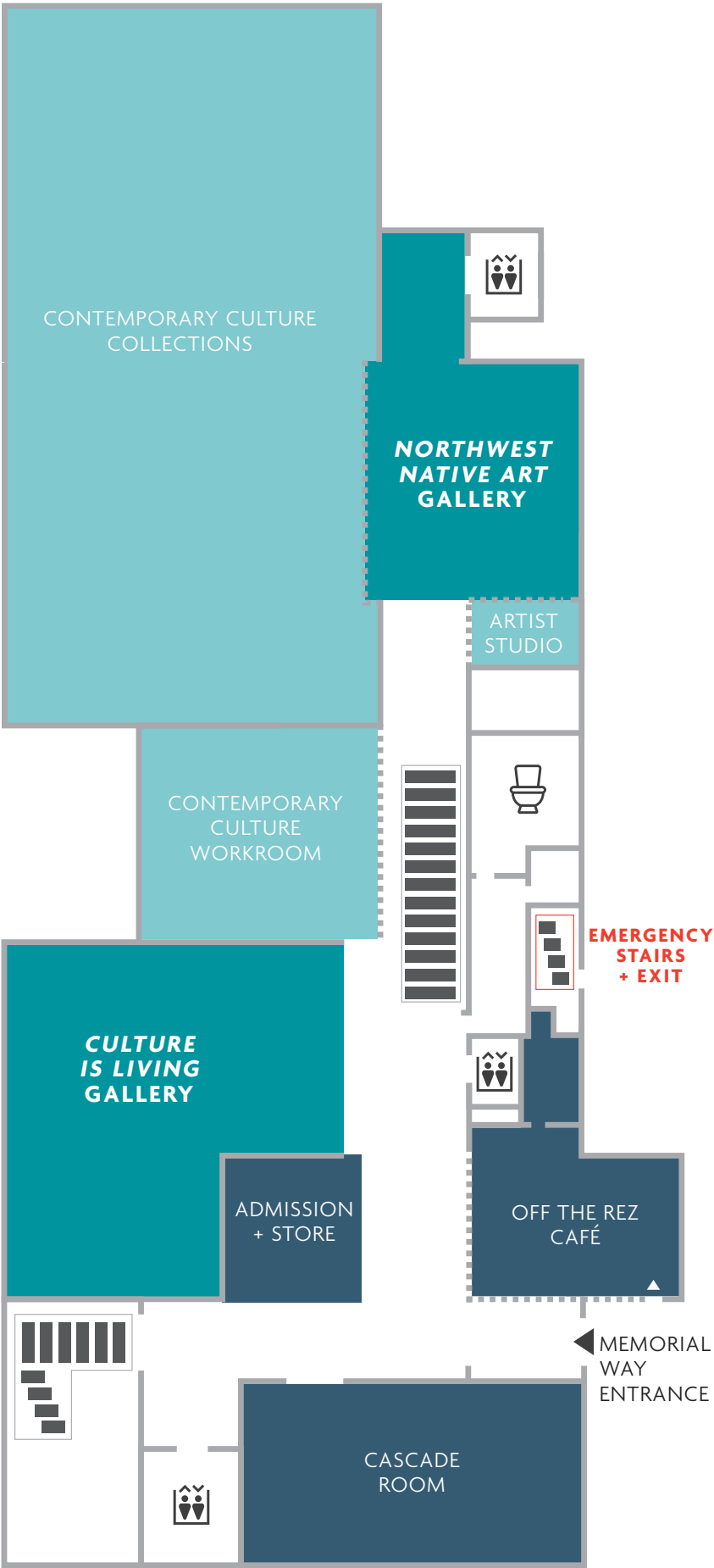

FIRST FLOOR HIGHLIGHTS

CASCADE ROOM

See one of Tiffany Studios' largest and most intricate windows, and historic Boiserie wood paneling

OFF THE REZ CAFÉ

Enjoy fry bread and other Native foods, coffee, beer, and wine

CULTURE IS LIVING GALLERY

See how objects embody the knowledge and stories of the people they come from

CONTEMPORARY CULTURE WORKROOM

Collections care, community consultation, and research

NORTHWEST NATIVE ART GALLERY

"What is your artistic heritage?" Six Northwest Native artists answer this question

ARTIST STUDIO

Hands-on space where artists create, learn, and share knowledge







SECOND FLOOR

Biology

Amazing Life Gallery

Special Exhibit Gallery

-  Accessible Restrooms + Changing Tables
-  Lactation Room
-  See-Through Locations
-  Elevator

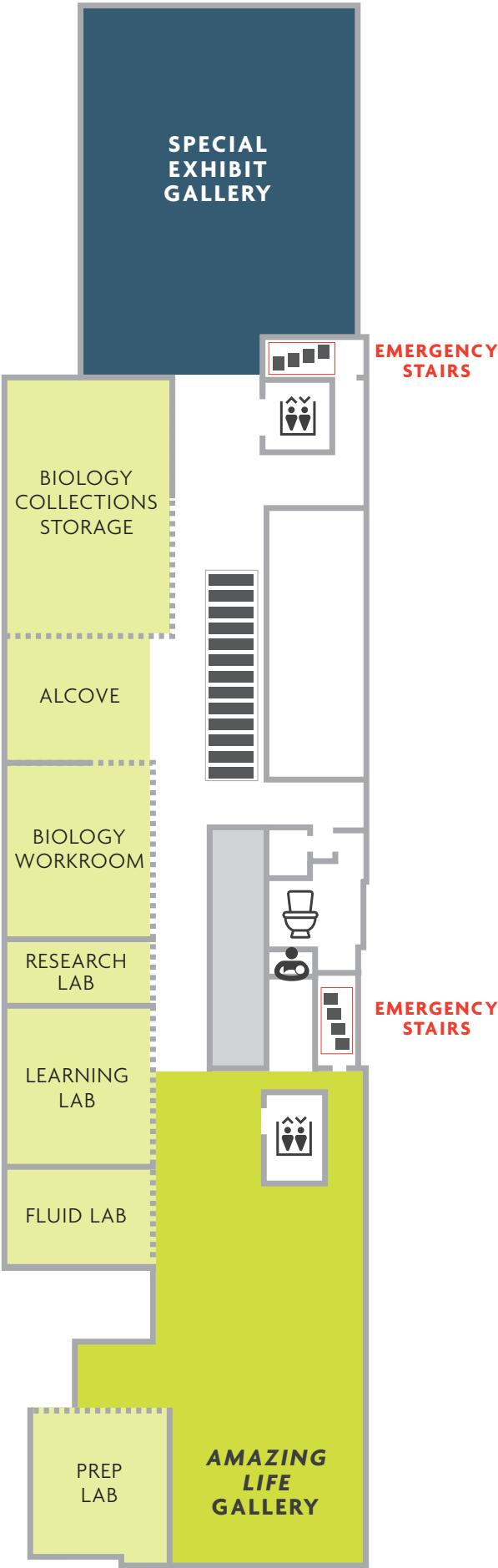

SECOND FLOOR HIGHLIGHTS

AMAZING LIFE GALLERY

Learn how 8.7 million species have evolved across time and space

BIOLOGY WORKROOMS & LABS

Collections care, specimen preparation, and research

“SYNECDOCHE” MURAL

A three-story artwork by RYAN! Feddersen, (Okanogan and Lakes)

SPECIAL EXHIBIT GALLERY

Tidal Breaks: Pause, relax, and reflect in an ocean-themed space

Up next: *Cruisin’ the Fossil Coastline*
(opening December 2020)



THIRD FLOOR



Archaeology

Our Material World Gallery

Contemporary Culture

Paleontology

Fossils Uncovered Gallery

-  Accessible Restrooms + Changing Tables
-  See-Through Locations
-  Elevator

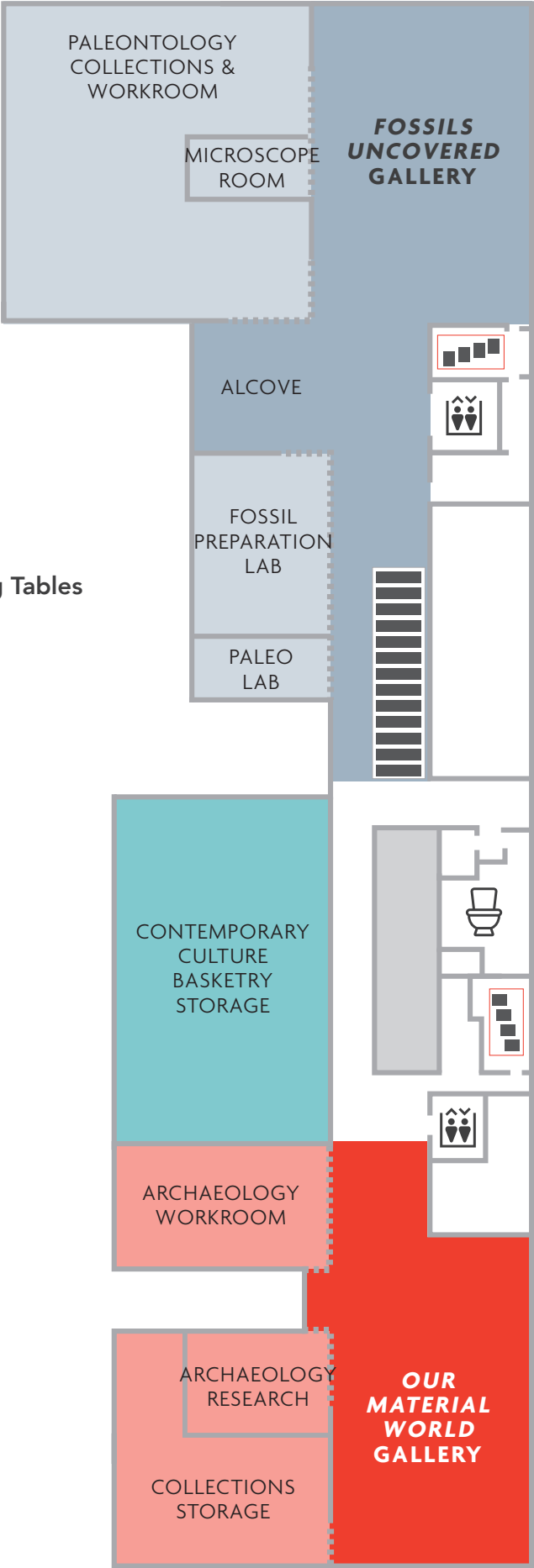

THIRD FLOOR HIGHLIGHTS

OUR MATERIAL WORLD GALLERY

"Stuff" reveals surprising truths about our lives

ARCHAEOLOGY WORKROOMS

Collections care, community consultation, and research

FOSSILS UNCOVERED GALLERY

Discover how fossils reveal evidence of Earth's transformation

PALEONTOLOGY LABS AND WORKROOMS

Collections care, fossil preparation, and research





THANK YOU FOR VISITING!

ACCESSIBILITY The Burke Museum welcomes people of all abilities. Our galleries, restrooms and museum spaces are designed in accordance with ADA specifications. Service animals are welcome at the Burke. Companion animals do not qualify as service animals and are not allowed in the museum. You may be asked if you have a service animal upon entry. Please ask for assistance at the admission desk.

HOURS 10 am – 5 pm, Tuesday–Sunday, last admission at 4:30 pm. Closed on Mondays. FREE and open until 8 pm on the first Thursday of each month.

FOOD & DRINK available from Off the Rez Café; outside food is allowed in the Cascade Room or outside in the Burke Yard.

LOST & FOUND items held at the admission desk, or contact: burkevis@uw.edu; 206.616.3962.

PHOTOGRAPHY and video without flash is allowed throughout the museum for personal use. Permission is required before filming or photography for press or commercial purposes. Please be considerate of staff and volunteers working; if photography is disruptive, visitors may be asked to put away cameras or phones.

RESTROOMS are all-gender throughout the museum. Shared, multi-stall and private, single-stall restrooms are located on every floor. By offering restrooms that are all-gender, the Burke Museum seeks to minimize structural barriers to access and create a space that is welcoming to all.