

# VISITOR GUIDE



# UNCOVER THE LIFE BEFORE YOU

## A MUSEUM FOR EVERYONE

Get up close to the Northwest's past, present, and future at the Burke. Featuring 12 state-of-the-art visible labs, views into collections storage spaces and an artists' workshop, see the work typically happening behind the scenes of a natural history and culture museum unfold right before your eyes.

At the Burke, you see—and feel—a world alive. Regardless of who you are or where you came from—whether your family just got here or has called this land home for millennia—**this is your museum.**

### LAND ACKNOWLEDGEMENT

The Burke Museum stands on the lands of the Coast Salish peoples, whose ancestors resided here since time immemorial. Many Indigenous peoples thrive in this place—alive and strong.

### MISSION

The Burke Museum cares for and shares natural and cultural collections so all people can **learn, be inspired, generate knowledge, feel joy, and heal.**

### AFFILIATIONS





# LOWER FLOOR

Lower Lobby/Grand Atrium

East Classroom

West Classroom

-  Accessible Restrooms + Changing Tables
-  Stroller Parking
-  Elevator

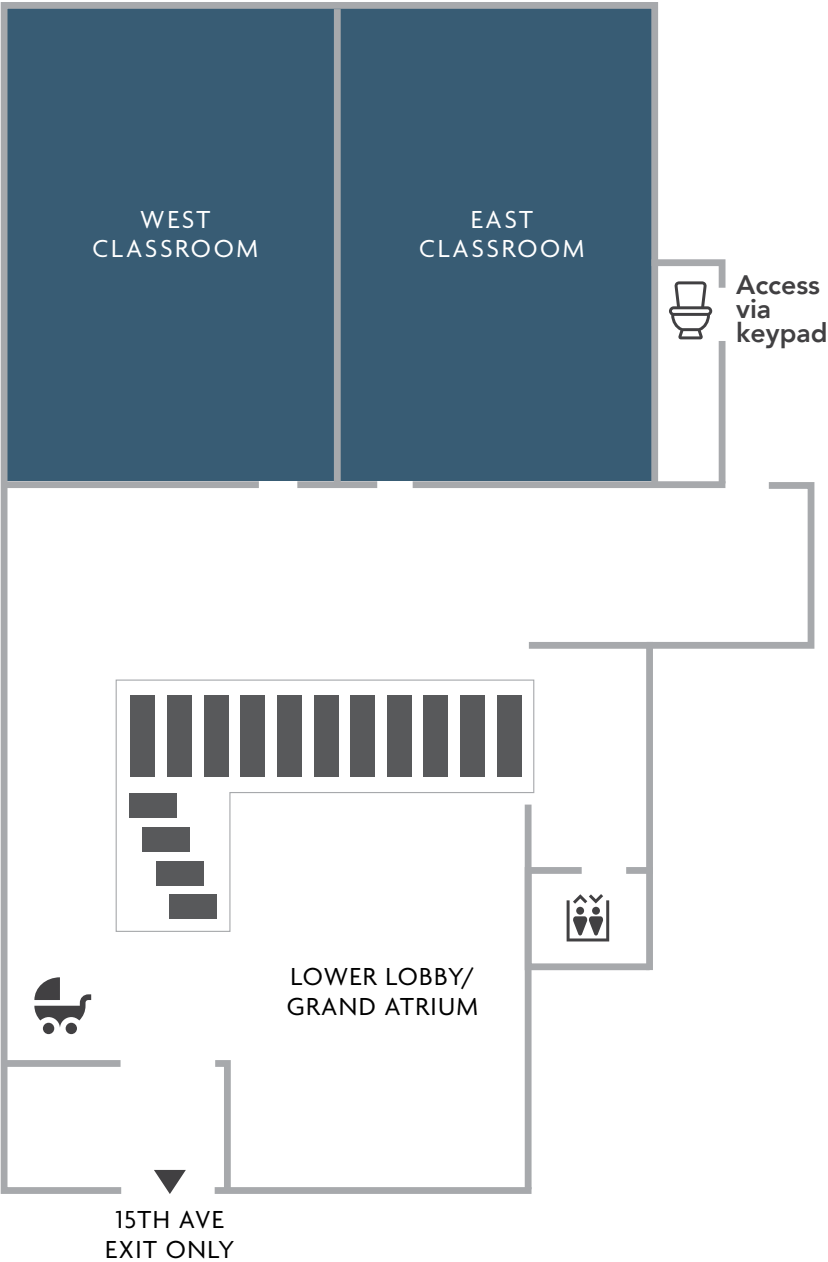

# LOWER FLOOR HIGHLIGHTS

---

Iconic objects of the natural history and cultures of Washington state welcome you to the Burke Museum and University of Washington campus.

**MASTODON** This 10,000-year-old mastodon helps us understand what life once looked like in the Pacific Northwest

**THE WEAVER'S WELCOME** This newly-commissioned piece—created by a team of Coast Salish artists—is a glass figure cast from hand-carved wood sculptures

**BAIRD'S BEAKED WHALE** One of 10 Baird's beaked whales in U.S. museum collections and offers incredible insights into a species that is rarely seen or studied

**PETRIFIED LOGS** These rocks were once trees that grew in eastern Washington 15 million years ago



# FIRST FLOOR

Arts & Cultures

Culture is Living Gallery  
Northwest Native Art Gallery  
Main Lobby

- Accessible Restrooms + Changing Tables
- See-Through Locations
- Elevator

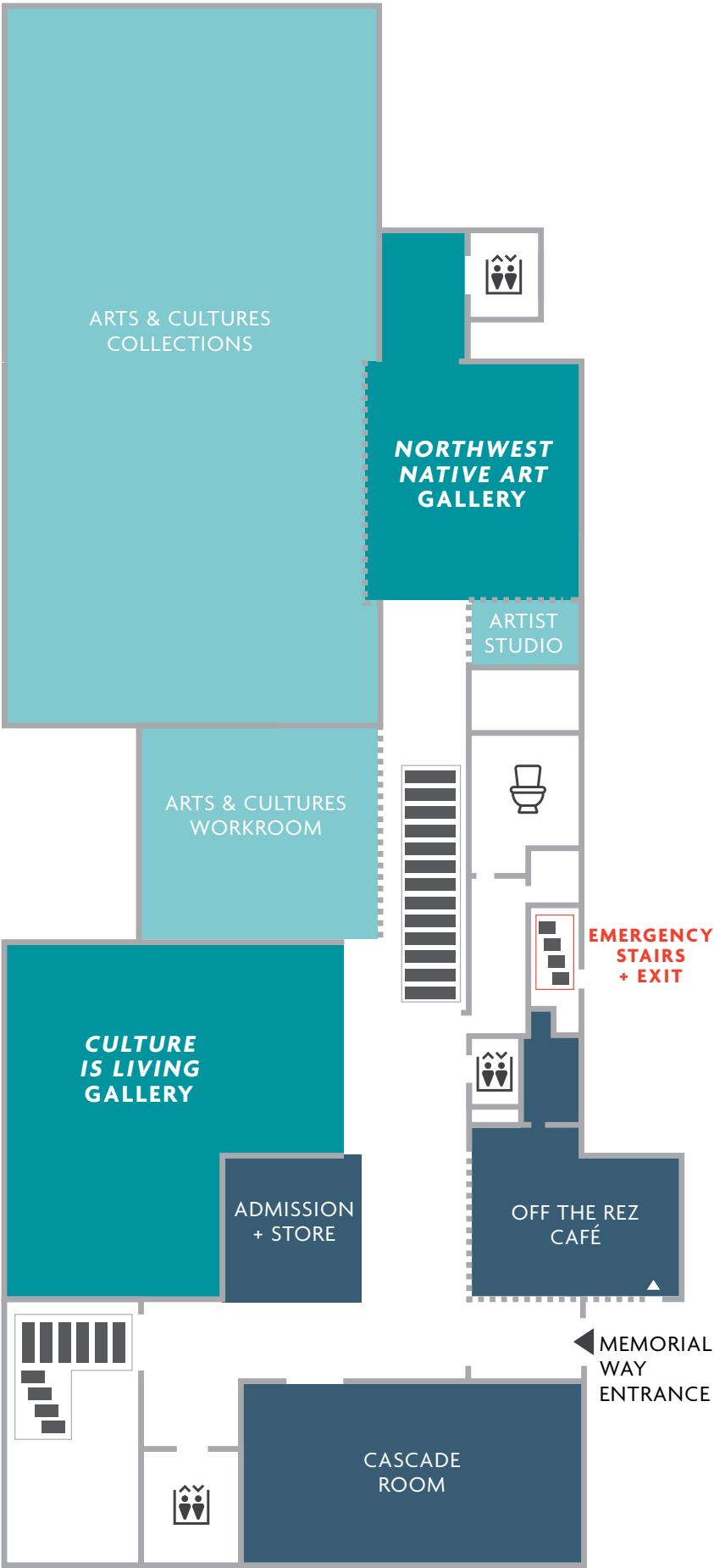

# FIRST FLOOR HIGHLIGHTS

---

## **CASCADE ROOM**

See one of Tiffany Studios' largest and most intricate windows, and historic Boiserie wood paneling

## **OFF THE REZ CAFÉ**

Enjoy fry bread and other Native foods, coffee, beer, and wine

## **CULTURE IS LIVING GALLERY**

See how objects embody the knowledge and stories of the people they come from

## **ARTS & CULTURES WORKROOM**

Collections care, community consultation, and research

## **NORTHWEST NATIVE ART GALLERY**

"What is your artistic heritage?" Six Northwest Native artists answer this question

## **ARTIST STUDIO**

Hands-on space where artists create, learn, and share knowledge







# SECOND FLOOR

**Biology**

Amazing Life Gallery

Special Exhibit Gallery

-  Accessible Restrooms + Changing Tables
-  Lactation Room
-  See-Through Locations
-  Elevator

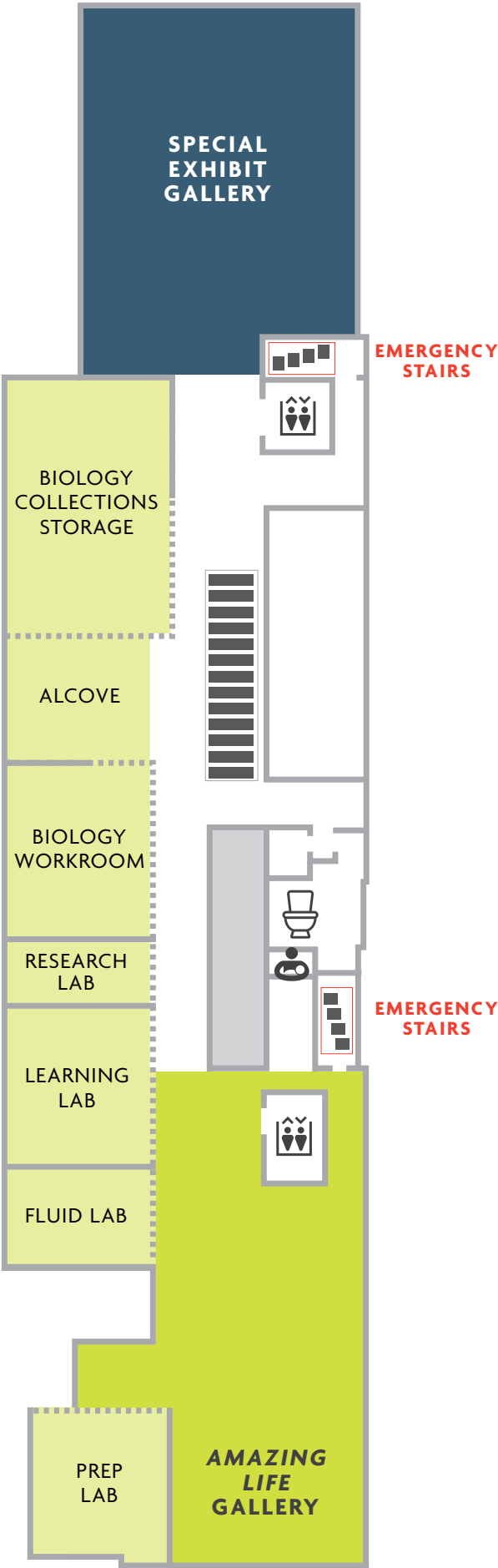



# SECOND FLOOR HIGHLIGHTS

---

## **AMAZING LIFE GALLERY**

Learn how 8.7 million species have evolved across time and space

## **BIOLOGY WORKROOMS & LABS**

Collections care, specimen preparation, and research

## **“SYNECDOCHE” MURAL**

A three-story artwork by RYAN! Feddersen, (Okanogan and Lakes)

## **SPECIAL EXHIBIT GALLERY**

*Life in One Cubic Foot*  
Open through July 17, 2022

From Seattle’s Seward Park to a coral reef in the South Pacific, *Life in One Cubic Foot* reveals the diversity of nature and inspires visitors to become community scientists.





# THIRD FLOOR



**Archaeology**

*Our Material World Gallery*

**Arts & Cultures**

**Paleontology**

*Fossils Uncovered Gallery*

-  Accessible Restrooms + Changing Tables
-  See-Through Locations
-  Elevator

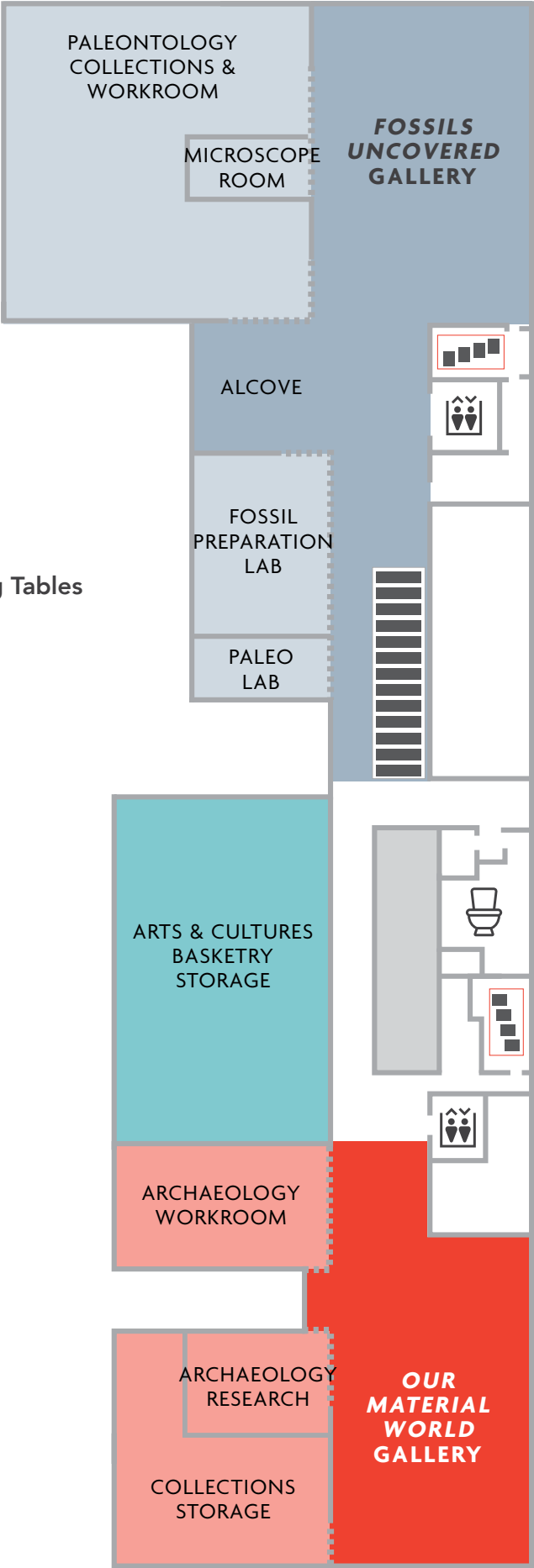

# THIRD FLOOR HIGHLIGHTS

---

## **OUR MATERIAL WORLD GALLERY**

"Stuff" reveals surprising truths about our lives

## **ARCHAEOLOGY WORKROOMS**

Collections care, community consultation, and research

## **FOSSILS UNCOVERED GALLERY**

Discover how fossils reveal evidence of Earth's transformation

## **PALEONTOLOGY LABS AND WORKROOMS**

Collections care, fossil preparation, and research





## THANK YOU FOR VISITING!

**ACCESSIBILITY** The Burke Museum welcomes people of all abilities. Our galleries, restrooms and museum spaces are designed in accordance with ADA specifications. Service animals are welcome at the Burke. Companion animals do not qualify as service animals and are not allowed in the museum. You may be asked if you have a service animal upon entry. Please ask for assistance at the admission desk.

**HOURS** 10 am – 5 pm, Tuesday–Sunday, last admission at 4:30 pm. Closed on Mondays. FREE and open until 8 pm on the first Thursday of each month.

**FOOD & DRINK** available from Off the Rez Café; outside food is allowed in the Cascade Room or outside in the Burke Yard.

**LOST & FOUND** items held at the admission desk, or contact: [burkevis@uw.edu](mailto:burkevis@uw.edu); 206.616.3962.

**PHOTOGRAPHY** and video without flash is allowed throughout the museum for personal use. Permission is required before filming or photography for press or commercial purposes. Please be considerate of staff and volunteers working; if photography is disruptive, visitors may be asked to put away cameras or phones.

**RESTROOMS** are all-gender throughout the museum. Shared, multi-stall and private, single-stall restrooms are located on every floor. By offering restrooms that are all-gender, the Burke Museum seeks to minimize structural barriers to access and create a space that is welcoming to all.

# WELCOME BACK GUIDELINES

New measures are in place to keep visitors, staff, volunteers, and our community healthy and safe. These guidelines allow us to care for each other and provide a positive experience while you're at the Burke. Please let us know if there is anything we can do to make your visit more enjoyable.

## MASKS

While masks are not required, we continue to welcome and encourage mask wearing for the protection of the most vulnerable members of our community.

## PHYSICAL DISTANCING

We encourage you to maintain physical distancing when possible.

## CLEANING PROTOCOLS

Additional cleaning is in place throughout the day, with an emphasis on high-traffic areas like restrooms, railings, door handles, and elevators.

## HAND SANITIZER

Hand sanitizer is available at the admissions desk, in the lower lobby, and other in areas throughout the museum.

## COATS + BAGS

Coat check and lockers are closed at this time. Backpacks, large bags, or items bigger than 11" x 15" are not allowed. Please plan ahead.

## FOOD AND DRINK

Food and drinks can be consumed in the Cascade Room off the main lobby. You are welcome to take food outside onto the lovely terraced steps.

## CAFÉ

Off the Rez Café is open with eat-in and to-go options. Limited seating is available inside the café and on the patio. Masks are encouraged, but no longer required.

## PARKING

Paid parking is available through UW kiosks with an option for touchless phone payment—more information available [here](#).